



KNAUF AKADEMIE

KNAUF





Welcome to the **KNAUF Akademie** in Accra!

Training is extremely important for KNAUF. It is one of our key ways of re-investing in all stakeholders and making sure that our end-user is completely satisfied. That is why in February 2019, the KNAUF Akademie was inaugurated in Accra.

KNAUF's success is built on our four values:

Menschlichkeit. We view ourselves, our clients and everybody else involved in our actions as part of one big family.

Partnership. We trust each other and can rely on each other.

Commitment. We assume responsibility for our work and consider the effects of our decisions.

Entrepreneurship. We act pragmatically, are result-oriented and use our opportunities.

These are the same values we expect to guide both the team, trainees, and visitors to the KNAUF Akademie in Accra to make sure that we build a strong network of applicators, staff, sales people, architects and engineers in Ghana.



Who are our Training Courses for?

If you are currently active in the construction industry or plan to become a stakeholder in this industry, our courses are for YOU!

Our regular courses are very practical and hands-on, and offer the sound theoretical basics needed for the subject matter. The courses are designed with a wide range of trainees in mind:

- architects
- civil engineers
- quantity surveyors
- plasterboard installers
- painters
- POP Installers
- building contractors
- DIY enthusiasts
- carpenters
- masons
- students

Special Courses

Special courses and sessions can be arranged on request for interested parties. We can offer training in subjects such as Fire Resistance, Acoustics, Safety Products among others. External Trainings can also be offered.

Registration for Training Courses

Registering for Training Courses at the KNAUF Akademie in Accra can be done at KNAUF Ghana or on our website, www.knauf.com.gh.

Facilities at the KNAUF Akademie

The Accra Training Center boasts of state-of-the-art facilities. Seminar rooms for theoretical training boast of all the necessary IT infrastructure.

A showroom shows a wide range of KNAUF solutions and enables trainees better visualise their work. The practical training area is equipped with tools and machinery to train up to 20 persons per session



Successfully Completing Your Course

We take our training courses very seriously, so to successfully complete a module, you must:

1. pass the written test
2. pass the practical test
3. actively participate in activities
4. be present at least 60% of the time

Aims of our Modules

By offering these course modules, we pursue two main aims. Firstly, we want to empower the trainee to become proficient at doing what they do, so that they can earn an income from using KNAUF products.

Secondly, our training modules aim to make your customers satisfied with the products and systems we deliver to them. Emphasis is paid on quality and paying attention to details in using KNAUF products.

Your Certificate and KNAUF Passport

In addition to a Certificate of Participation, you may receive a KNAUF Passport.

The KNAUF Passport is your personal marketing tool which gives a record of all the courses you've successfully completed at the KNAUF Akademie.

You can show this to prospective clients to let them know that you've received training from us - they can verify directly from us.

Payment

Courses at the Training Center are not free simply because 'what is free is not valued'!

The fee paid covers giveaways, daily lunch, and training materials during the course.

BASIC

Drywall Basics (Partitions and Ceilings)

Trainees will be taught the basics of building KNAUF wall partition systems and plasterboard ceilings.

On successful completion, the trainee should be able to build a KNAUF wall partition W111 with door and window openings. Additionally, the trainee should be able to build a KNAUF ceiling D112 with integrated access panel and split level.

Duration:
4 Days



KNAUF Gypsum Plastering

Trainees will be taught the basics of Gypsum Plastering. Both the manual and mechanical application will be trained.

Duration:
2 Days



INTERMEDIATE

After successful completion of the three BASIC Modules, trainees can register for the intermediate courses. In total, eight (8) Intermediate Modules will be offered:

Acoustic Ceilings. Installation of ceiling with Cleaneo.

Modular Ceilings. Installation of a AMF modular Ceiling Tiles.

Performance Walls. Wall system with higher technical requirements.

Aquapanel. Installation of Aquapanel Cement Boards.

MP 75 for Ceilings. Gypsum Plastering for Ceilings.

External Rendering. KNAUF external rendering products.

MP 75 Fire. Installation of MP 75 Fire.

Decorative Techniques and Finishes. Advanced techniques for Plasterboard ceilings and walls.

t.b.a.

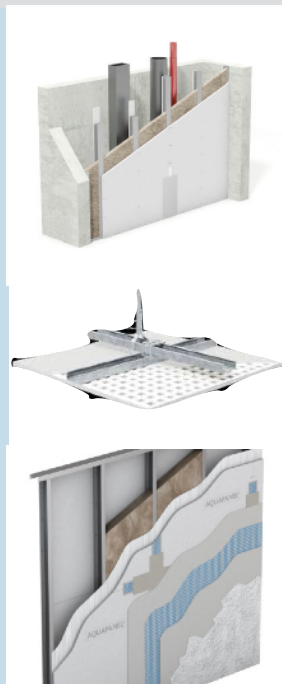

ADVANCED

Advanced Acoustics. Advanced Theoretical Course in Acoustics.

Advanced Fire. Advanced Theoretical Course in Fire.

t.b.a.



KNAUFINSULATION

AQUAPANEL®



KNAUFDANOLINE

Heradesign®





Opening Hours

Mon - Fri : 08:30 - 16:30

Training Times

Training Sessions are held during Opening Hours. Contact us for when the next session is open.

Accommodation

The Training Center does not have accommodation facilities. We can however help you find suitable accommodation close to that us.

Feeding

Lunch will be provided daily during the Training Course.

Payment

Payment for training modules can be done by cash, card or mobile money.

Directions to KNAUF Akademie



You will find the Training Center by searching for 'KNAUF Ghana' on Google Maps.

Landmarks close to the centre are 'Old Melcom' and 'Ghana Revenue Authority, North Industrial Area.'



KNAUF Ghana Limited

KNAUF Training Contact:

+233 (0) 553 412 492

www.knauf.com.gh

training@knauf.com.gh

All rights reserved. All amendments, reprints and photocopies, including those of excerpts require the express permission of KNAUF Ghana Limited. Information in this manual is not binding.

Training Guide V22019

KNAUF Ghana Limited
38 Dadeban Road
North Industrial Area
Accra - Ghana

info@knauf.com.gh